

GROUNDWATER MONITORING

Water Table Elevation (MSL + 100 Feet)

Shallow Saturated Zone - Depth 30 to 50 feet bgs

SACRAMENTO REGIONAL WASTEWATER TREATMENT PLANT - Prepared 5/19/2018

February 2018

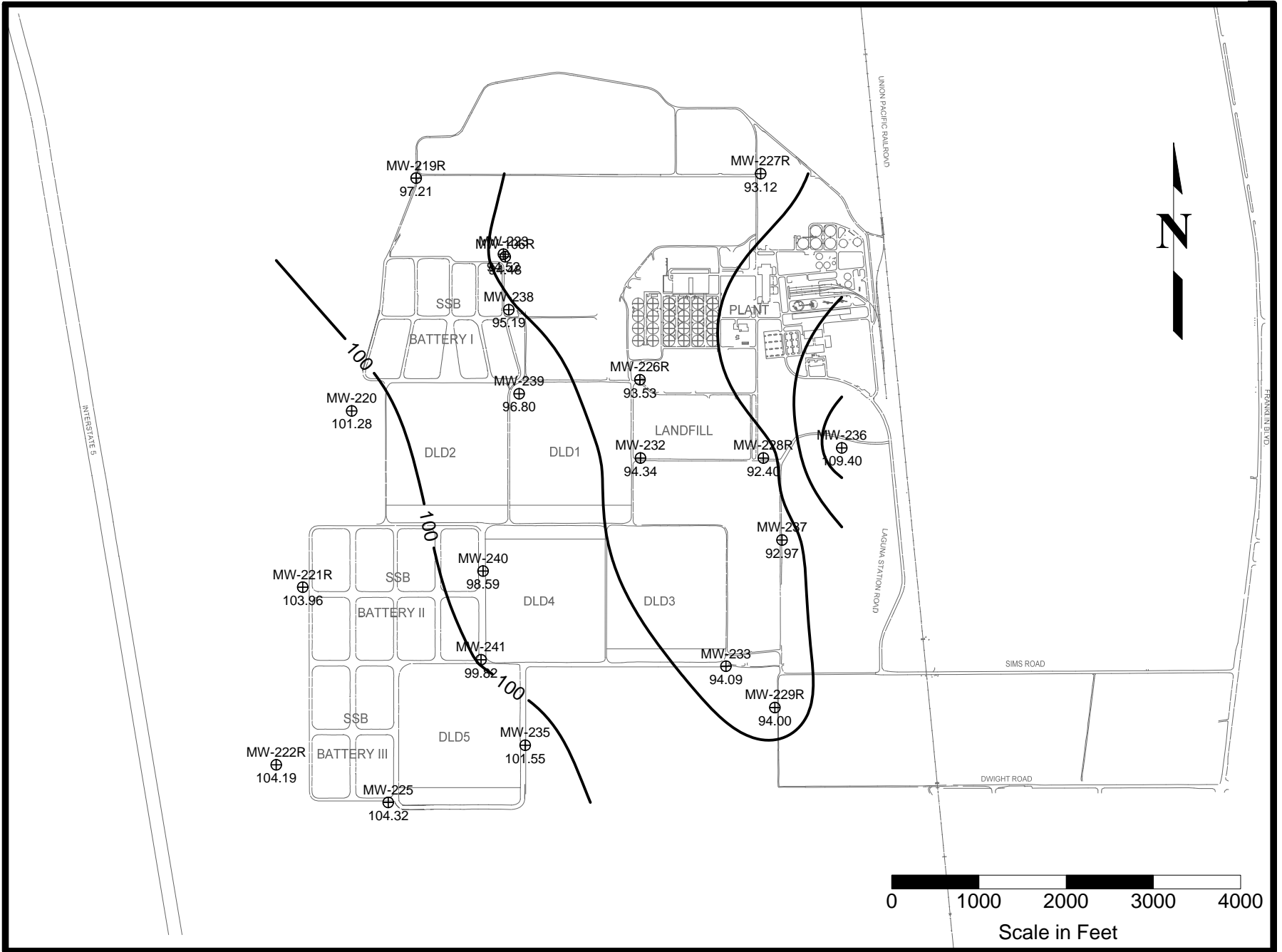

GROUNDWATER MONITORING
Water Table Elevation (MSL + 100 Feet)
Shallow Saturated Zone - Depth 30 to 50 feet bgs
SACRAMENTO REGIONAL WASTEWATER TREATMENT PLANT - Prepared 6/8/2018

April 2018

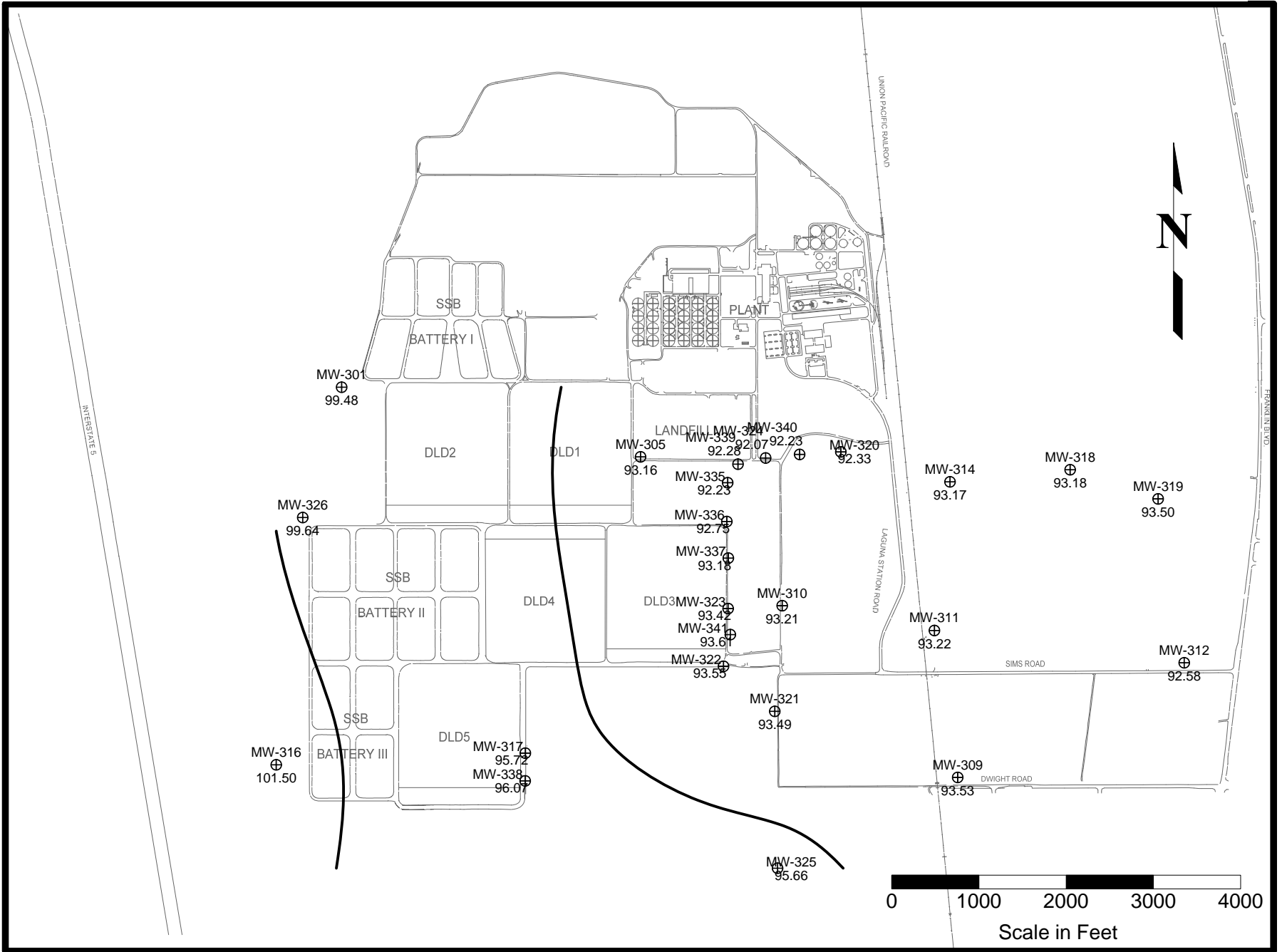

GROUNDWATER MONITORING
Water Table Elevation (MSL + 100 Feet)
First Aquifer - Depth 50 to 75 feet bgs
SACRAMENTO REGIONAL WASTEWATER TREATMENT PLANT - Prepared 5/19/2018

February 2018

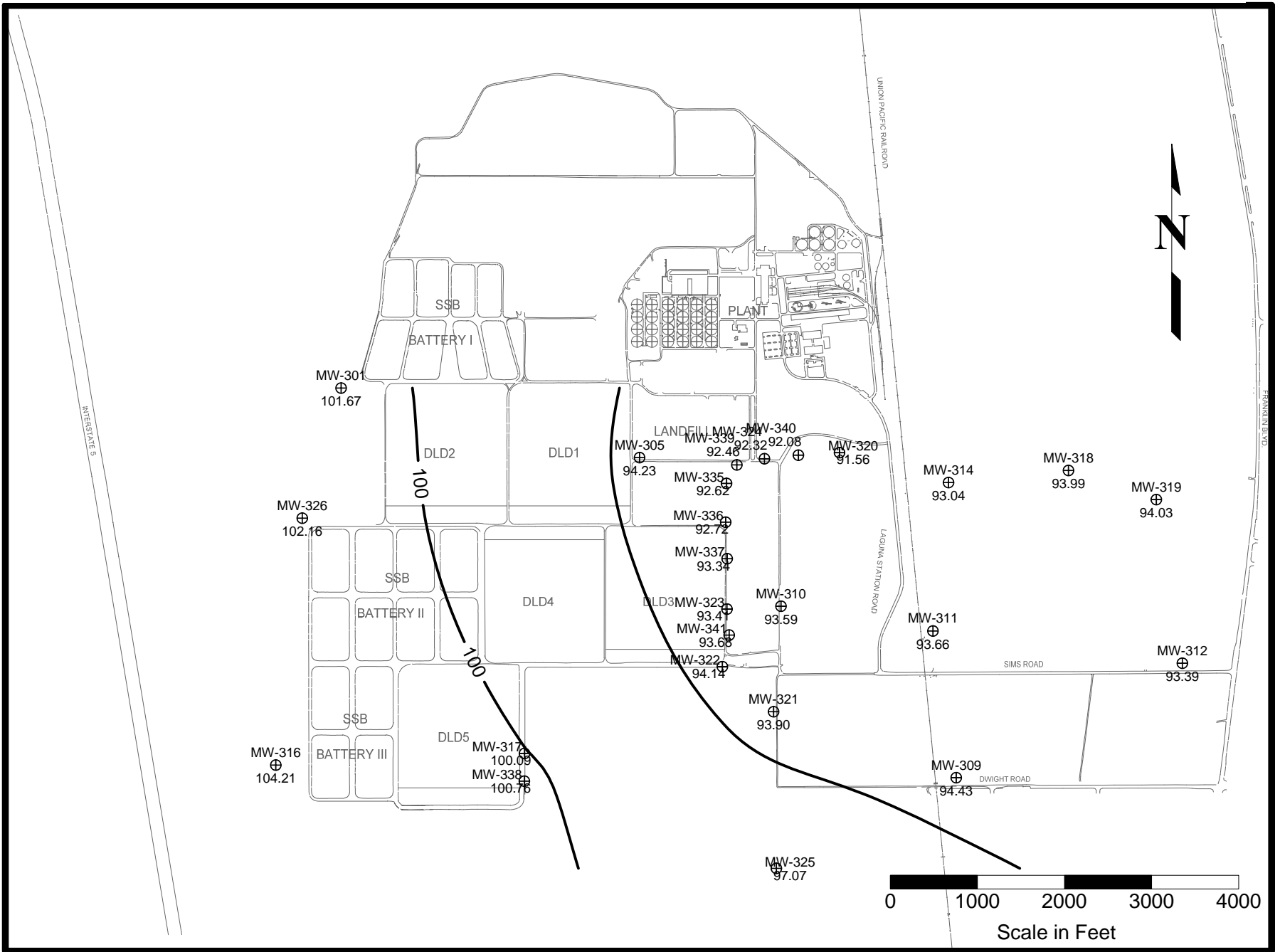

GROUNDWATER MONITORING
Water Table Elevation (MSL + 100 Feet)
First Aquifer - Depth 50 to 75 feet bgs
SACRAMENTO REGIONAL WASTEWATER TREATMENT PLANT - Prepared 6/8/2018

April 2018